

1. Introduction

The OnQ 5 Port Network Interface, Rt. Angle Module, PN 364407-01, provides a convenient structured interconnect for local area network (LAN) applications such as 10BASE-T Ethernet.

Figure 1 shows a view of the module. The module is to be mounted in OnQ Raised-Rail or Flat-Rail Service Center Enclosures.

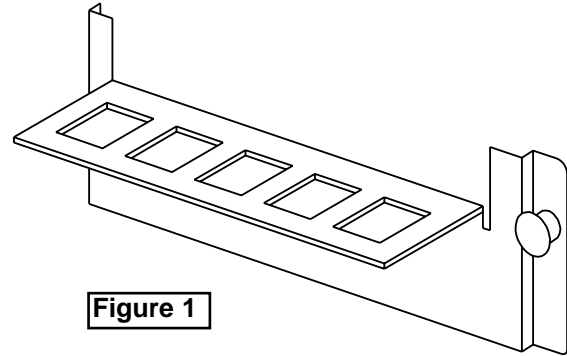

Figure 1

2. Description

The Network Interface Module includes five (5) category 5E RJ45 Modular Jack connectors for connecting to outlets located throughout the house.

3. Installation

A. Mounting plate in enclosure - Refer to *Figure 2*.

- 1) Align tabs on the module with slots on rail of enclosure.
- 2) Insert tabs by angling module away from the back of the enclosure.
- 3) Rotate the module and insert fasteners on module into corresponding holes on rail of enclosure. (Plunger must be in a pulled position for fastener to engage hole.)
- 4) Push plunger in to lock module in place. Pull on module to ensure module is locked properly in place.

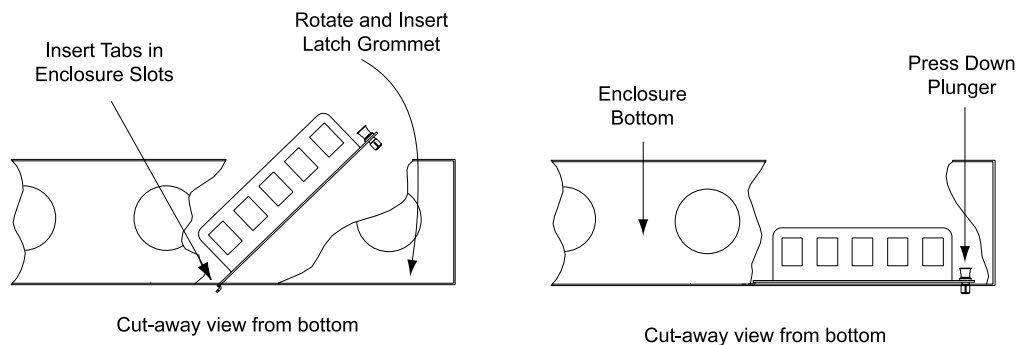

Figure 2

B. Port-Outlet Cable Termination

- 1) Identify outlet cable and route to modular jack assemblies. In routing cable, allow slack for bundling to the side and avoiding other cable terminations. Trim cable about 3 inches beyond connector opening.
- 2) Strip off approximately 4 inches of the outer jacket using OnQ Strip Tool PN 363292-01 or equivalent.
- 3) Maintain cable identification throughout to easily identify outlets to be networked. For RJ45 Modular Connector Assemblies, position pairs over color-coded slots as per *Figure 3*.

NOTE: RJ45 Modular Jack connector assemblies are terminated according to EIA/TIA 568A Telecommunications Wiring Standard.

NOTE: Do not untwist pairs.

NOTE: White wires may not have color trace stripe. Keep white wire paired with appropriate colored wire based on twist.

- 4) Without untwisting cable, position the wires in individual slots.
- 5) Punch-down and trim wires using OnQ Punch-Down Tool PN 363293-01 or equivalent.

NOTE: Palm Tool, PN 364378-01, will ease termination.

- 6) Remove excess wire and tug slightly on cable to ensure wire is securely installed in assembly.
- 7) Install strain relief caps over terminations.
- 8) Repeat until all outlets are connected.

C. Final Installation

- 1) Remove module from enclosure.
- 2) Install terminated connectors into module; snap in place as shown in *Figure 4*.
- 3) Re-install module in enclosure. Be sure wires are not pinched or pulled out of the connector.
- 4) Record room number to module position number.

D. Securing Cables.

After all cables are connected to the module, the cables should be bundled and grouped to allow ease of maintenance. OnQ Wire Management Straps, PN 363491-01, may be used to bundle cable.

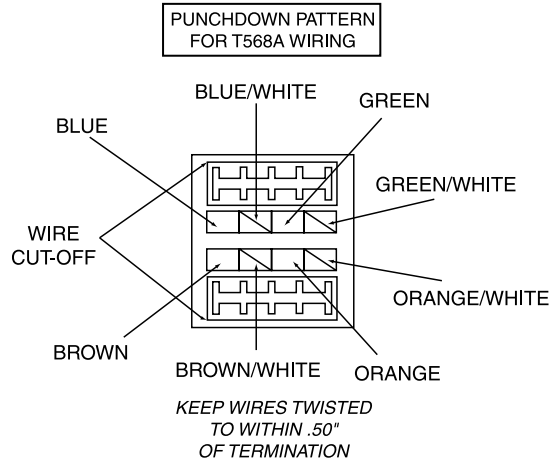

Figure 3

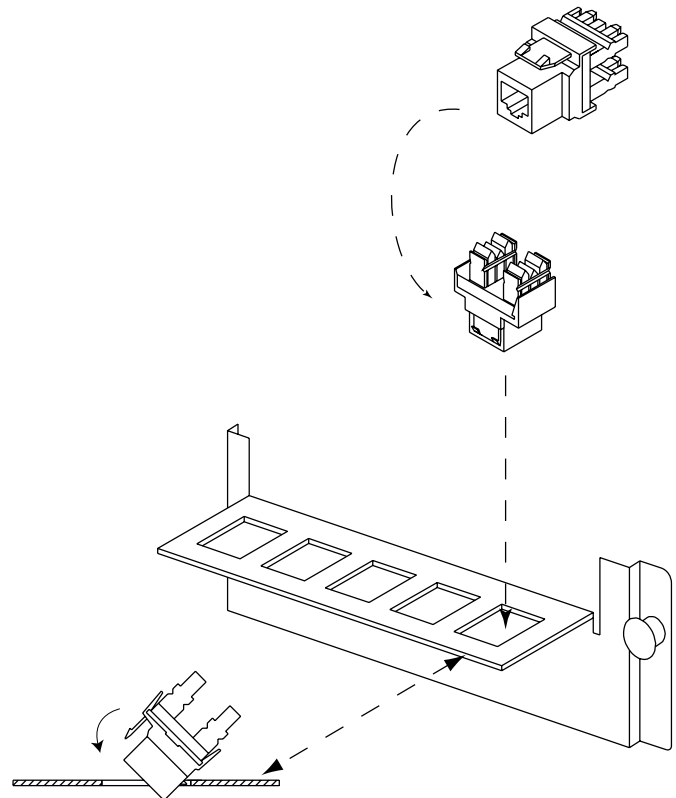

Figure 4