

Instruction/Installation Sheet

Grommet Installation for Custom Enclosures

IS-0221 Rev. 0

INSTALL BUSHING, P/N 100627-01, INTO KNOCKOUT BY INSERTING ONE SIDE (AS SHOWN) AND THEN SNAPPING REMAINING EDGE INTO PLACE.

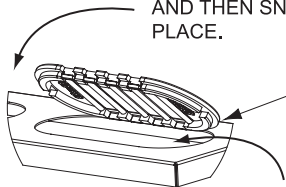

START INSERTION HERE

REMOVE "KNOCKOUT" FIRST

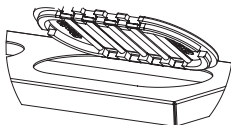

FRONT VIEW

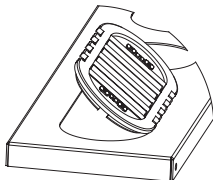

SIDE VIEW