

# Quad Tiler

## Installation Notes

### Important Safety Precautions

READ ALL INSTRUCTIONS CAREFULLY AND COMPLETELY BEFORE INSTALLING THE QUAD TILER.

- **Do not** attempt to service, move or change any component of this system unless you are qualified to do so.
- This system must be installed by an authorized installer and must conform to all local building and electrical codes.
- **Do not** apply power to the Quad Tiler until all components have been installed and all wiring has been properly terminated.
- **Do not** attempt to terminate, change or un-install any wiring without first turning off power at the Quad Tiler which is located in the enclosure. Unplug the power transformer that is powering the Quad Tiler from the power outlet before proceeding with wiring terminations or changes.
- Install each component of this system **away** from heat sources such as heating ducts/registers, stoves or any other heat source.
- **Do not** expose any component that was designed for indoor use to moisture. Doing so can create electrical hazards or render the component unusable. Exposure to moisture will also void the warranty on the system.

### Installation and Operation

#### Mounting

- Attach the included mounting bracket into the enclosure using the push rivet fasteners that are included.
- Use the appropriate push rivet fasteners for your enclosure according to the label on the push rivet fastener packaging.
- The Quad Tiler is designed to rest in the mounting bracket.

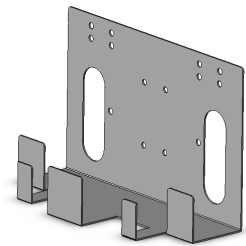

Mounting Bracket

#### Connections

- Connect up to four cameras to the "VIDEO IN" ports on the back of the Quad Tiler by using the included RCA to BNC cables.
- The output of the Quad Tiler can be sent to a modulator or other device by using a RCA to BNC cable and connecting it to one of the two output BNC connectors. For quad mode, connect to the "QUAD ONLY" output and for manual switching mode connect to the "SWITCH" output.
- Connect the Quad Tiler to power by using a 12 volt 200mA power supply (not included), or by utilizing the multi-voltage power distribution module.

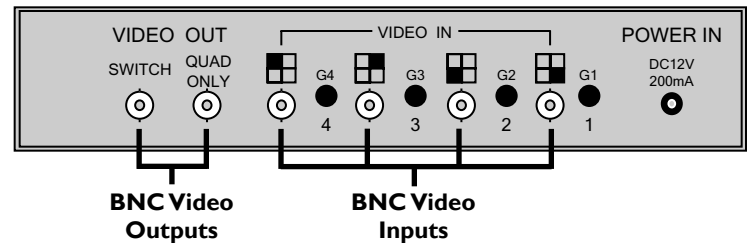

#### Operation

There are three modes of operation that the Quad Tiler can operate in: quad, switching and full screen.

- **Quad Mode:** Use the BNC output labeled "QUAD ONLY" and press the "QUAD" button on the front of the Quad Tiler. The output will consistently display all four cameras on one screen and all other buttons of the front panel will not function.
- **Switching Mode:** Use the BNC output labeled "SWITCH" and press the "SWITCH" button on the front of the Quad Tiler. The output will sequence through five displays which are each individual camera plus the quad display. The Quad Tiler will show each display for 4 seconds.
- **Full Screen Mode:** Use the BNC output labeled "SWITCH" and press a button above the camera which you would like to view. This camera will be displayed until another camera or mode is selected.

### Application Example

**PLEASE NOTE:** Components such as power supplies are not shown in the diagram but may or may not be included with the products shown. Please consult the current catalog for more information on required parts and components.

The Cat 5 Camera System consists of a Cat 5 Camera Module, RJ-45 terminated cameras, and peripheral devices such as modulators and quad tilers. The Cat 5 Camera module can support up to 4 cameras through the use of an onboard tunable sequencer, and is compatible with single and multi-channel modulators. The camera module also provides power to the camera over the Cat 5, further reducing the number of installed cables.

The diagram to the right illustrates a typical Cat 5 Camera System configuration utilizing the Quad Tiler. The quad tiler is modulated onto a single RF channel and is then distributed throughout the home video system.

